

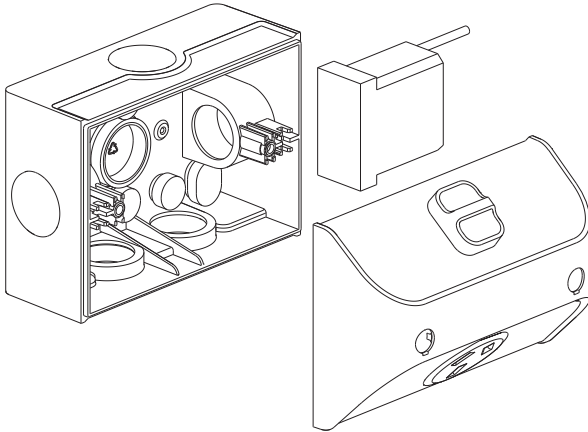

A brand of **legrand**

Aqua with Netatmo Smart Single Powerpoint Instruction Manual

RWL787IOTMG



This product is a connected accessory which requires you to buy and install the Arteor with Netatmo Starter Kit (AWNSKIT Series) or Basic Kit (AWNBKIT Series) first.

1 Things to consider before installation

To control your Aqua with Netatmo socket, you can either use a smart device (phone or tablet) or an Arteor with Netatmo wireless switch (AWNWSW1 series).

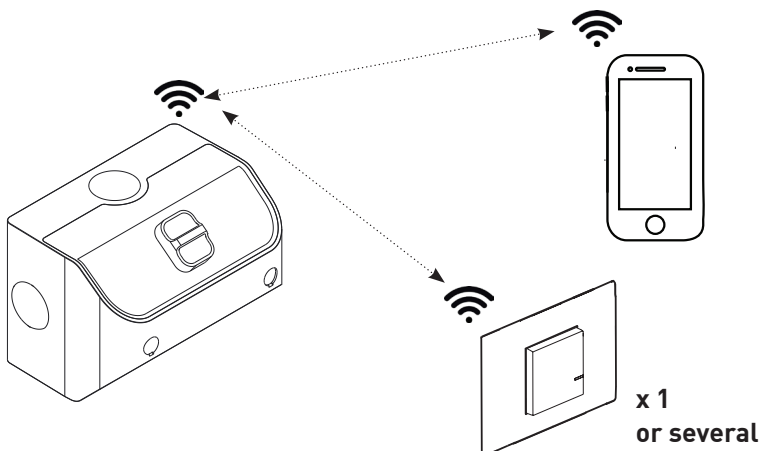

Note: Wireless switch and phone shown above are not included in this pack.

! Do not use: Arteor with Netatmo smart light switch (AWNVSx series or AWNHSx series) or smart dimmer switch (AWNVDM1 or AWNHDM1 series) to control your Aqua with Netatmo Smart Single Powerpoint.

2 Installation

- The powerpoint should be wall mounted on the structure with screws. (not provided)
- All entries must be sealed with an appropriate sealant and applied according to sealant manufacturer instructions.
- When mounting the box to a wall, drill holes for fasteners in the correct position, seal around the edges of the box, and fit the supplied caps.
- When fitting the cover to the box, make sure the gasket is free of dirt and seated correctly. Tighten screws securely.
- Failure to follow the manufacturers instructions will void the manufacturers' warranty.

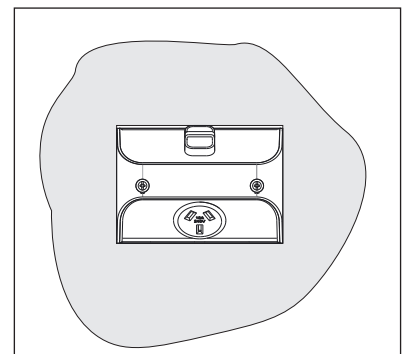
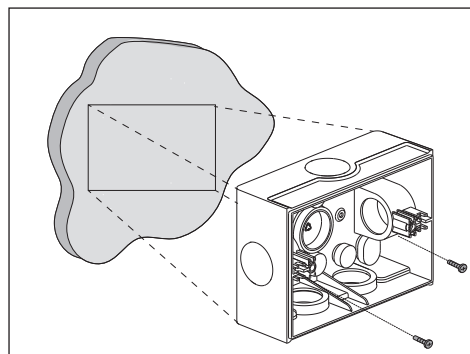

3 Wiring the Smart Socket Module

- N (Neutral) = Blue/Black
- L (Active) = Brown/Red
- ⚡ (Earth) = Green/Yellow

(2.5mm² rigid wire recommended)

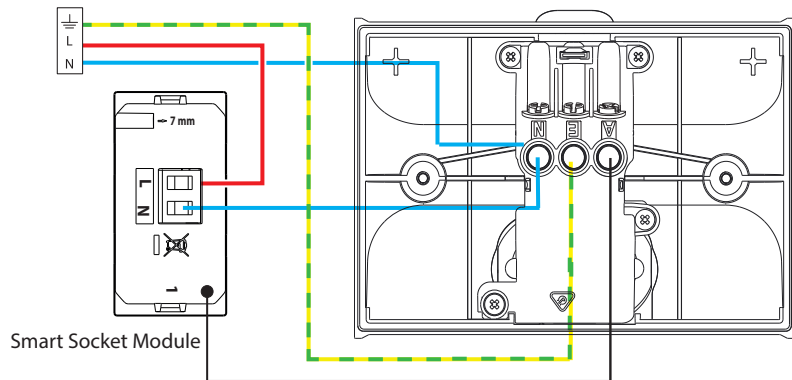

Frequency bands: 2.4 - 2.4835 GHz
Power level :<100mW

4 Setting the Smart Single Powerpoint

- Ensure the Smart Socket Module is readily accessible and front LED indicator is visible.
- All the "with Netatmo" products must be powered back ON simultaneously. To achieve this, use the Main Switch rather than individual sub-circuits.
- Press and hold the centre of the Wireless Master Switch (provide with Arteor with Netatmo Starter kit or Basic kit) until it lights briefly in GREEN then release.
- Wait for the Smart Socket Module front LED indicator to turn GREEN.
- Press the centre of the Wireless Master Switch, it will flash 3 times then goes OFF.
- Launch the Legrand Home + Control app, go to settings/Add a new product section and follow the tutorial prompts.
- Once set up is finished, switch off the Main Switch and put the Smart Socket Module back into the Aqua powerpoint base and screw the front cover back on.
- Turn the Main Switch back ON.

5 Product Notes

1. This product must be installed and used as per these instructions. **2.** This product must be installed by a licensed electrician. **3.** An IP rating of IP53 is generally considered suitable for external walls with supplementary protection such as overhanging eaves. **4.** The IP rating of this product is only valid when all applicable seals, glands and their appropriate cables are installed correctly. **5.** The IP rating of this product is only valid when installed on flat and non-porous surfaces. Additional sealing may be required for irregular surfaces. **6.** The fixing screws on this product should be tightened to a maximum torque of 0.8Nm. Over tightening may damage the product. **7.** This product contains no serviceable parts and no attempt should be made to repair this product. If the product is faulty it should be discarded. **8.** This product has been designed to operate in ambient temperatures 5°C to 35°C. **9.** Extended exposure to UV rays (such as exposure to direct sunlight) may cause discolouration of this product. **10.** This product is not suitable for installation in hazardous and/or corrosive areas. **11.** The material in this product may vary in colour from batch to batch. Colour matching from one batch to another cannot be guaranteed. **12.** This product has been designed to operate on a nominal supply voltage of 230V - 6% to 240V a.c. + 6%. **13.** Legrand reserves the right to modify the specifications of this product at any time. **14.** This product utilises intellectual property in the form of registered designs, trademarks, and/or patents. Such intellectual property remains the property of Legrand in cases.

Warranty

Legrand will honour all statutory guarantees that you as a consumer are entitled to rely upon under the Australian and New Zealand Consumer Laws against a manufacturer including a guarantee that this product is of acceptable quality.

To make a claim under any statutory guarantee you should first contact the supplier, or retailer from whom you purchased this product.

Customer Service

For all Customer Service and Technical Support please call Monday to Friday during business hours.

Legrand Australia
1300 369 777
www.hpm.com.au

Legrand New Zealand
0800 476 009
www.hpm.co.nz

ABN: 31 000 102 661